

Pentrepoeth Primary School

Monday 1<sup>st</sup> September 2025

# Newsletter



‘creating a **Caring, Respectful,**  
**Open Environment**  
where **Success and**  
**Opportunity** flourish’

# This Week's Information

Dear Parent and Carer,

Welcome back to the Autumn term and to the new academic year. I trust you have had an enjoyable summer. Please find enclosed some important and routine information for the start of term 2025-26.

We are very much looking forward to welcoming new Nursery and Reception children to school this term. We will also be welcoming a number of children in year groups across the school I am sure you will all settle in very well.



## Drop Off and Pick Up

A reminder that there is **no parent parking on site**. We ask parents to park away from school and walk in via one of our entrances. May I once again ask parents to consider the health of children and to turn car engines off and not leave them idling as children walk past. Also, we want to be considerate neighbours. Please do not park in front of people's drives or on pavements. It is essential that you do not block the gates at the front and back of the school – these need to be clear at all times for emergency vehicle access. **If at all possible, please walk children to school!**

Children should not arrive to school until 8.50am as there is no pupil supervision at this time and children remain the responsibility of parents. **At pick up children in years Rec, 1, 2 and 3 should be collected by an adult from the classroom door.** Children in Years 4, 5 and 6 may walk home unaccompanied as long as we have parent permission. Year 3 are allowed, with permission from the summer term.

**Year 3 Pupils – A reminder to parents that pupils in Years 3 to 6 finish school at 3:30pm**

On the next page is a map of the school which shows, particularly for new parents where to drop off and pick up at the start and end of the day.

EVERYONE IS WELCOME IN OUR SCHOOL.  
No one is the same, but everyone is equal.





# Pentrepoeth Primary School

## Map

**Please Note**

X – Indicates where children can enter their classrooms.

**5EJ – Mrs Jones – Year 5** – Children will need to enter at the side entrance (Lane to Fox) in the mornings and will be dismissed through the main office doors at the front of the school. Morning entrance marked with O

Side Entrance  
Lane to Fox

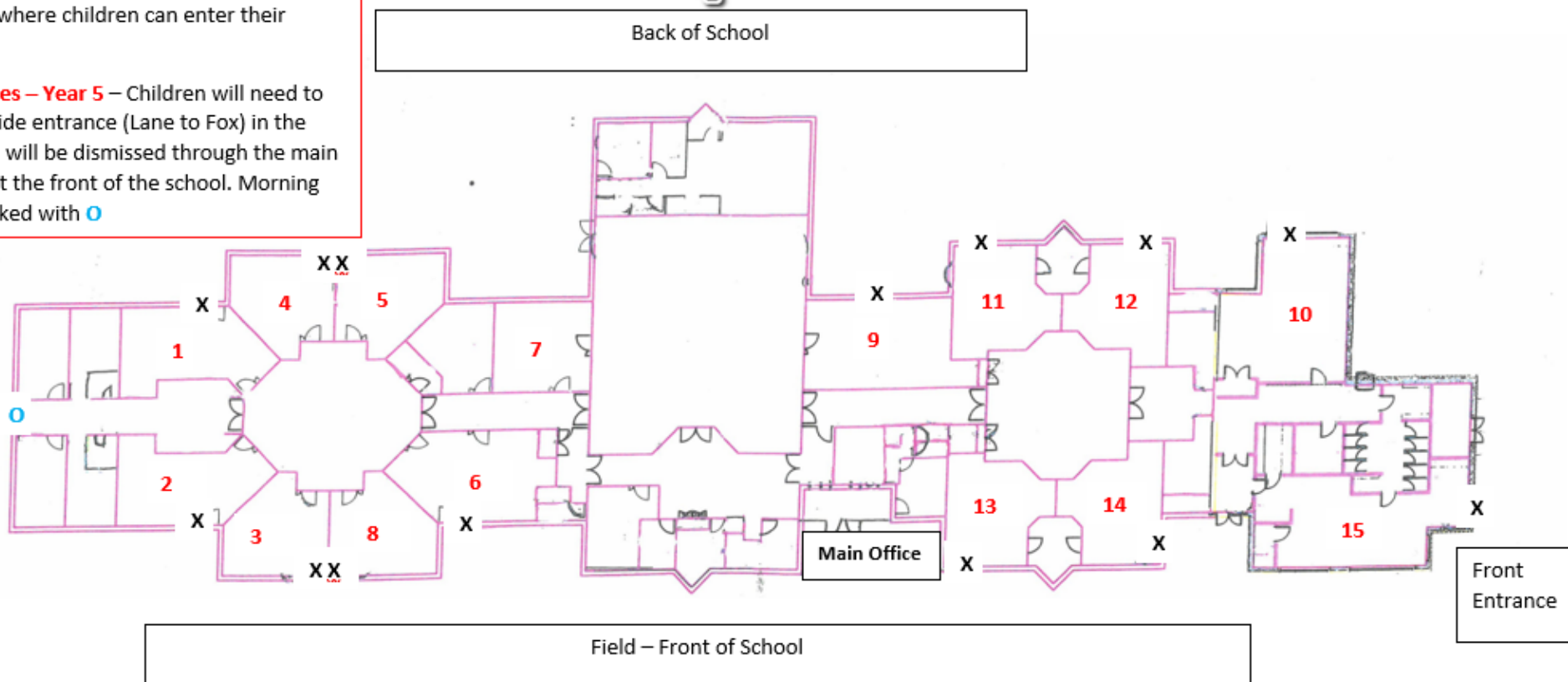

## Key

6 – 6RH – Mr Hall - Year 6 2– 6TM – Mr Merriman – Year 6	8 – 4LN – Mr Nocivelli – Year 4 3 – 4SA – Mrs Ahern – Year 4	Reception 9 – RAD – Mrs Drummond 10 – RJB – Mr Brewer	13 – 2GB – Miss Blair – Year 2 14 – 2JB – Mrs Beard – Year 2
7 – 4SA – Mrs Jones – Year 5 1 – 3JR – Mrs Gooding – Year 5	4 – 3JR – Mrs Rose – Year 3 5 – 3CC – Mrs Clissold – Year 3	Year 1 11 – 1FC/SH – Mrs Cleaves/Miss Hall 12 – 1SW – Mrs Williams-Chard	15 – Nursery – Miss Ellis

# This Week's Information

## Absence and Attendance

If your child is absent please telephone or e mail the school by 9.10am in the morning informing us of the reason for absence. When children manage at least 95% attendance this will have a hugely positive impact on the standards they achieve. **School policy states that no term time holidays will be authorised this coming academic year.** An online form for any absence needs to be submitted via the website **at least two weeks before** the absence is planned. Link here : [Absence Request Form](#)

If you have any questions on any attendance matters please do not hesitate to contact the school office for support and advice.

Please see letter from Director of Education regarding attendance [here](#)

## Keeping In Touch

We are always looking at ways in which we can improve our communication. We have several ways in which we will keep in touch:

**Text Message** – we will send regular texts as usual with reminders of events /important information.

**Newsletters** – these will be sent out every Monday and include school information and events.

**X** – classteachers will post regularly. Instead of the regular weekly learning updates that appeared in the weekly newsletters this will now appear on the class X page on a Friday. You can follow the main school X account @PentrepoethPrim. A list of class X accounts is listed at the end of this newsletter.

**Website** – all newsletters and events as well as a range of other can be found on our school website – [www.pentrepoethprimary.co.uk](http://www.pentrepoethprimary.co.uk)

**E Mail** – as always please contact us via the school e mail [Pentrepoeth.primary@newportschools.wales](mailto:Pentrepoeth.primary@newportschools.wales) if you need to communicate with us.

# This Week's Information

## School Lunch Provision

Parents and carers can access the current Primary School menu by logging in to their ParentPay account. Simply visit [www.parentpay.com](http://www.parentpay.com) and activate your account via the Account Login area on the home page of the site.

If you have not already received a unique activation username then please contact the school office on: 01633 631679

Details of your Username and Password should be kept safe and secure. More information on school meals, including menu choices can be found by clicking [here](#).

**A reminder that all children are now entitled to a free school lunch. Of course, children may continue to bring in a packed lunch if you prefer. New Reception Parent Pay log ins will be sent home by the end of the week. Reception children should be provided with a packed lunch for the first week.**

## School Uniform and PE Kit

We do not insist on children wearing school uniform with a logo. Whilst we do have a uniform supplier where you may purchase uniform with the school logo on it all we ask is that the children are in the school or nursery colours as outlined in our school prospectus. If you have old uniform that is not needed, in a good clean condition, then please consider donating it back to the school for us to reuse.

PE uniform is – **plain red top, black shorts or joggers and trainers.**

Forest school uniform – Plain red hoody, black joggers or shorts. Please bring wet weather trousers, coat and wellies as appropriate. Rec – Year 2 should bring wellies into school and they can remain in school.

# This Week's Information

## School Uniform and PE Kit

**Jewellery** – must not be worn to school for PE.

**Labels** -Please could all parents ensure all pupils' clothes, PE kits, bags etc. are all clearly labelled with names.

Pupils can wear their PE kits to school on their PE and forest school days. These are listed below.

Year Group	Day	Activity
Reception	Friday	PE (Indoors) & Forest School
Year 1	Tuesday	PE (Indoors) & Forest School
	Friday	PE (Outside)
Year 2	Monday	PE (Outside)
	Tuesday	PE (Inside) & Forest School
Year 3	Thursday	PE (Outside) & Forest School
	Friday	PE (Indoors)
Year 4	Wednesday	PE (Indoors)
	Thursday	PE (Outside) & Forest School
Year 5	Wednesday	PE (Outside) & Forest School
	Monday	PE (Indoors)
Year 6	Thursday	PE (Indoors)
	Wednesday	PE (Outside) & Forest School



# This Week's Information

## Administration of Medicine

We do not routinely administer medication, only as part of an agreed medical plan. If your child requires medication, please ring school and speak to Mr Cleaves.

Please could all medications (part of medical plans) such as EpiPens be brought to school on Tuesday 2<sup>nd</sup> September. Parents will need to bring them to the main office and sign the medication in via our medical forms provided.

Could any parents of pupils who have asthma pumps please let the office know via the school email so we can ensure our records are up to date.

If parents need to visit school to administer medication during the school day it is important that a medication administration form is completed before you leave school.

## Assemblies

Our assemblies will follow one of our monthly values. As usual we will be holding my 'Red Book' assembly on a Friday. Teachers will be awarding certificates to children for their learning and achievements. We will be focussing in on awards for children who have demonstrated being:

Ambitious and capable, enterprising and creative, ethically Informed, healthy, confident Individuals

### Outside Achievements

Has your child achieved something special outside of school?

Please let us know and we can all celebrate fantastic achievements in our Pupil Voice assemblies on Wednesdays. Please bring in any trophies, medals or certificates so that we may share and celebrate success together

EVERYONE IS WELCOME IN OUR SCHOOL.  
No one is the same, but everyone is equal.



# This Week's Information

## Healthy Eating

Please ensure your child brings in some fruit, vegetables and a drink (**water only** as per WG guidelines). Children will be able to refill these.

## Change of Details

If your details have changed, please inform the school by e mail. It is really important that we have up to date contact and emergency contact details.

## After School Clubs

These will start Monday 15<sup>th</sup> September and will be available to book on Parentpay next week. Information on the range of clubs offered will be sent by the middle of next week.

## Breakfast Club

Information regarding breakfast club can be found on our school website by following the attached link here <https://www.pentrepoethprimary.co.uk/breakfast-club>

Booking and payment for Breakfast club ( early bird option ) is available via Parentpay.

EVERYONE IS WELCOME IN OUR SCHOOL.  
*No one is the same, but everyone is equal.*





# This Week's Information

## Nut allergies

We have a number of children with severe nut allergies. No nuts are allowed in school including products that contain nuts. Please check before sending in lunch boxes.

## Mobile Phones

Please do not send mobile phones to school with your child. If children need to make phone calls during the day they will be able to use the school telephones in the main office. School will not be able to accept any responsibility for any items that are lost or damaged.

## No Dogs on Site

No dogs are allowed to be brought onto the school site in the interests of all pupil, parent & staff safety

## No Smoking Policy

The school is designated a no-smoking area. This also includes any areas near the school gates. These rules also apply to any electronic forms of cigarette.



# This Week's Information

## Social Media

Let's help our children prepare for the future and help them to be responsible if using any form of social networking sites, including text messaging and gaming. The minimum recommended age to open an account on Facebook, X, Instagram, TikTok and Snapchat is 13. Primary aged pupils should not be using these social media apps.

We fully recognise the value that YouTube has in today's education, but the YouTube policy recommends account holders need to be 18 years of age. If your child is able to use group chat forums on Playstation or Xbox games, then please monitor their use closely as they use age appropriate games. We want all of our children to be safe and we ensure that we have regular lessons that cover many aspects of online safety. Please can you help us to help our children be safe and responsible online.

As stated when you filled in your initial forms, we will continue with the consent that you have provided. If you change your mind, please e mail school so that we may update our records.

### GDPR – Processing Information

Our website holds details on how we process your children's data in our school processing notice.

We will be in touch before the end of the week with a calendar of dates and events for your diary for the 2025-26 school year.

I look forward to seeing you and welcoming your children back to school.

Kind regards,

Dean Taylor  
Headteacher



EVERYONE IS WELCOME IN OUR SCHOOL.  
*No one is the same, but everyone is equal.*





# Click For More Information...

